

### MT RHS09/13 FEED S7C

**MAINTENANCE TECHNIQUE**  
UNDERGROUND DRILL RELIABILITY

MT Parts: 0407 059 610  
1 Halsey Circuit, Roseworthy S.A. 5371  
171 Dugan Street, Kalgoorlie W.A. 6430  
parts@mtunderground.com  
www.mtunderground.com

**DRILL STEEL SUPPORT**

ITEM	PART NUMBER	DESCRIPTION	QTY
1	MT3125 0634 00	BUFFER - FRONT	1
2	MT3128 3253 34	HOUSING	1
3	MT3128 0000 34	PISTON	2
4	MT3128 3251 52	LID	2
5	MT0335 2165 00	CIRCLIP	2
6	MT3128 0000 36	WEAR PLATE	2
7	MT3128 0002 53P	WEAR PLATE	2
8	MT9111 4363 95P	PROTECT PLATE	1
9	MT3115 1746 06	RESTRICTOR (D=1mm)	2
10	MT9111 4363 56	FRONT PLATE	1
11	MT3128 3065 42	ATTACHMENT PLATE	2
12	MT3128 3257 46	SHIM	1
13	MT9111 4363 60BK	BOLT KIT	1
14	MT3128 3253 33SK	SEAL KIT	1
15	MT3128 3253 33RK	REBUILD KIT incl. items 3, 4, 5, 7, 8 & 14	1

**GRIPPER JAW**

ITEM	PART NUMBER	DESCRIPTION	QTY
16	MT9111 0003 27	BUSHING HALF 32 (32 Dia)	0
16.1	MT9111 0003 27T	BUSHING HALF 32T (32 Dia - no step)	0
16.2	MT3128 0002 51	BUSHING HALF 38 (38 Dia)	0
16.3	MT3128 0002 51T	BUSHING HALF 38T (38 Dia - no step)	0
16.4	MT3128 0007 64	BUSHING HALF 45 (45 Dia)	0
16.5	MT3128 0007 64T	BUSHING HALF 45T (45 Dia - no step)	0

### MT3128 3145 CA CUTTINGS MAT / GUIDE SYSTEM

ITEM	PART NUMBER	DESCRIPTION	QTY
1	MT9111 4363 690	PROTECTION MAT S7C	1
2	MT3128 3149 H1	HOUSING	1
3	MT3128 3149 H2	HOUSING	1
4	MT3128 3149 CABK	BOLT KIT	1

### GUIDE BUSH

ITEM	PART NUMBER	DESCRIPTION	QTY
5	MT3128 3146 32	GUIDE BUSH ST32 (50 Dia)	0
5.1	MT3128 3146 38	GUIDE BUSH ST38 (60 Dia)	0
5.2	MT3128 3146 45	GUIDE BUSH ST45 (72 Dia)	0
5.3	MT3128 3146 77	GUIDE BUSH 45/76 (76 Dia guide tube)	0

### MT3128 3158 86CA ROD HANDLER HOSE TREE

ITEM	PART NUMBER	DESCRIPTION	QTY
1	MT3128 3158 86	ROD HANDLER HOSE TREE BASE	1
2	MT3128 3158 86P	ROD HANDLER HOSE TREE COVER	1
3	MT9106 2478 2W	INPUT ADAPTOR - TWO WAY (grippers)	1
4	MT9106 2483 442	INPUT ADAPTOR - FOUR WAY (dual prox system)	1
5	MT9106 2483 2C	PROTECTION COVER	1
7	MT3128 2538 18	GREASE DISTRIBUTOR BLOCK	1
8	MT1110 0023 31	CLAMP	2
9	MT9106 0630 10	DOUBLE CHECK VALVE	1
9.1	MT4090 0630 00	M5 x 90 SHCS (for the removal of OEM double check valve)	4
10	MT3217 6513 01	RESTRICTOR (0.6mm)	2
11	MT1211 1227 015	SIGNAL CABLE (1.5m gripper input)	4
12	MT9106 1511 51	LED SIGNAL CABLE (1.5m caro input LED)	1
13	MT1211 1221 015	SIGNAL CABLE (1.5m caro input)	1
14	MT1211 1221 045	SIGNAL CABLE (4.5m linear sensor)	1
15	MT9106 2478 30	SIGNAL CABLE	2
16	MT2320 2320 090	SENSOR CABLE (9.0m boom cable)	2
17	MT2320 2310 024	SENSOR CABLE (2.4m boom cable extension)	2
18	MT3222 1488 083	GRIPPER PROXY SENSOR (1300mm IP69)	2
19	MT3128 3158 FK	FITTINGS KIT	1

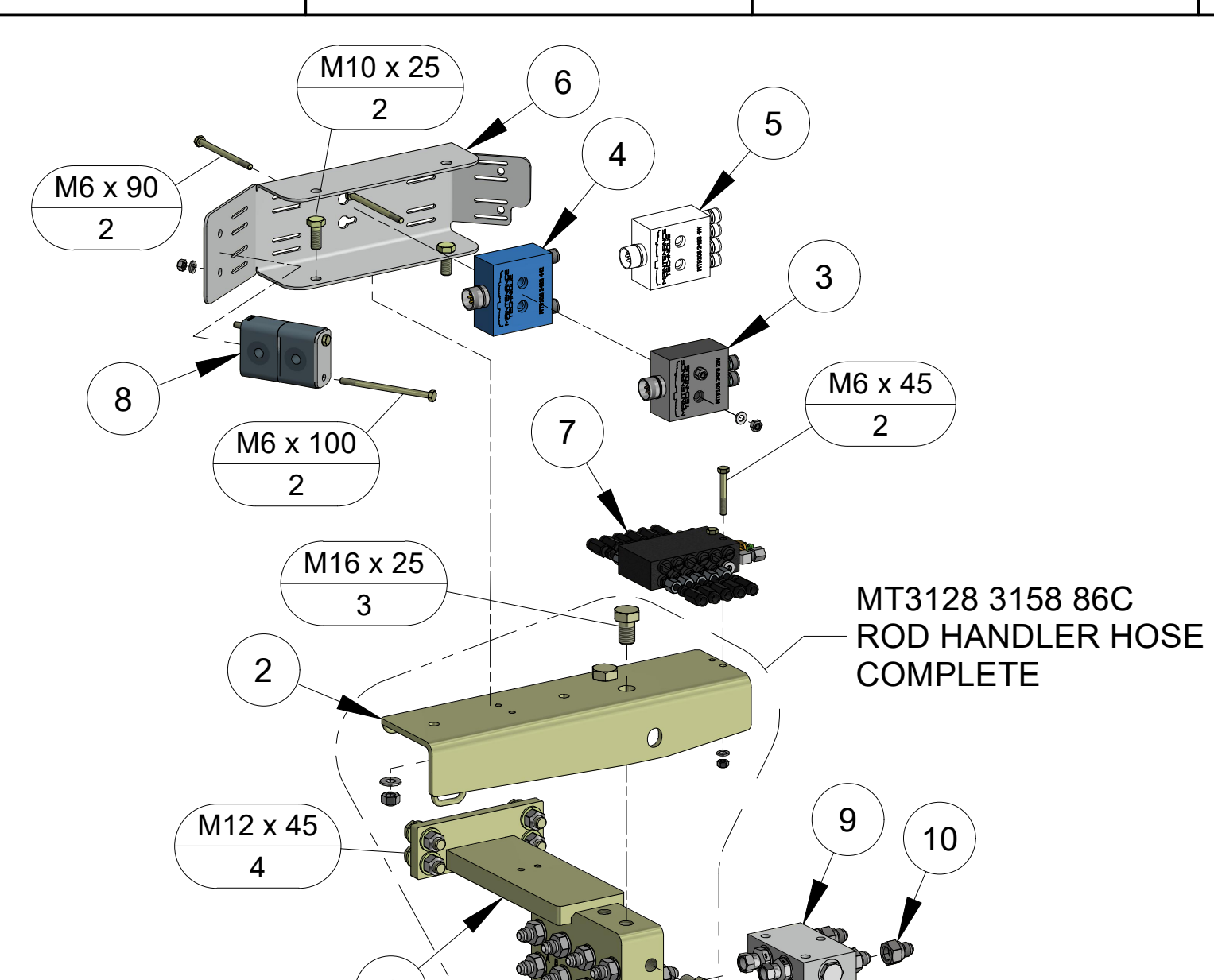

### MT9106 2478 28 SPLIT INPUT CABLE GRIPPERS DUAL PROX SYSTEM

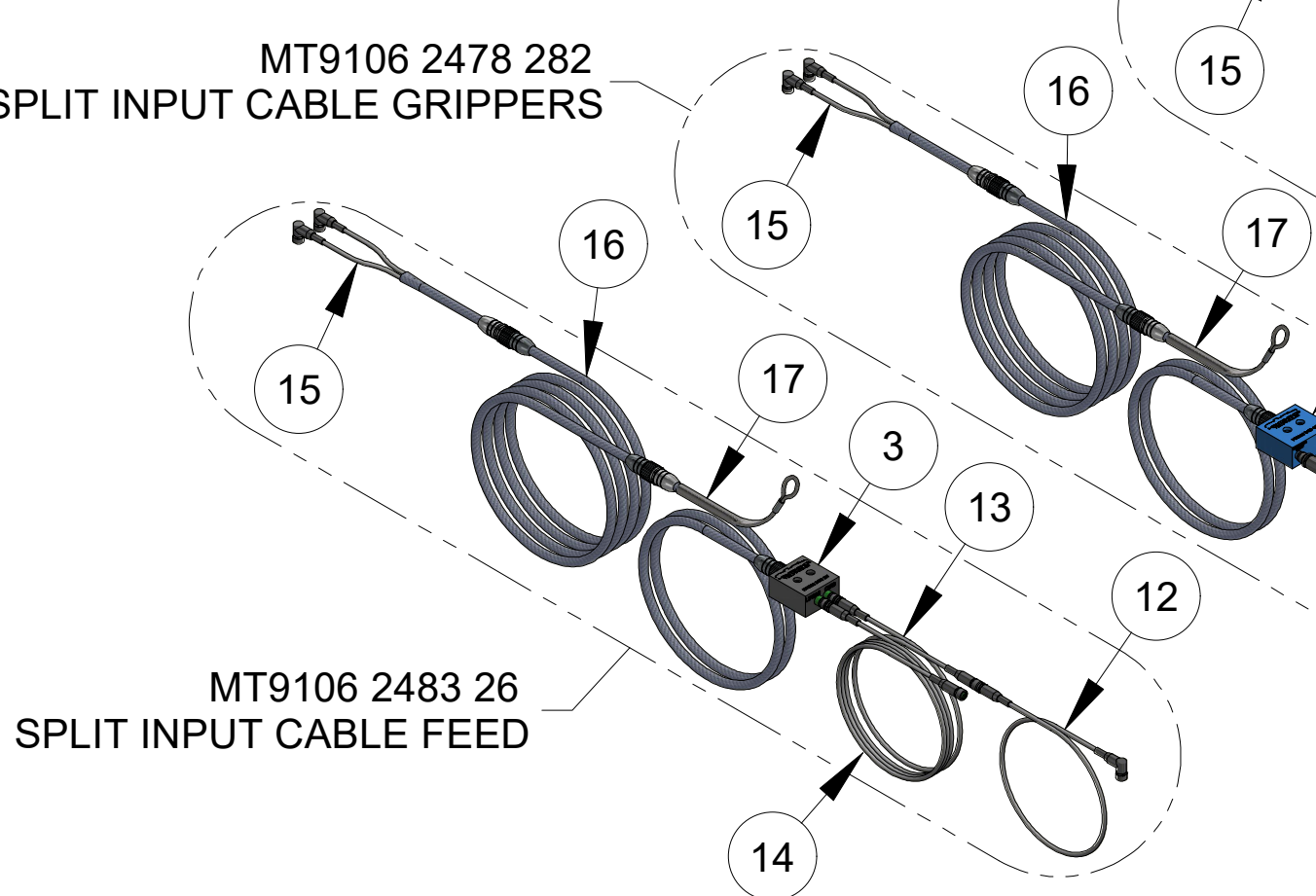

### MT9106 2483 26 SPLIT INPUT CABLE FEED

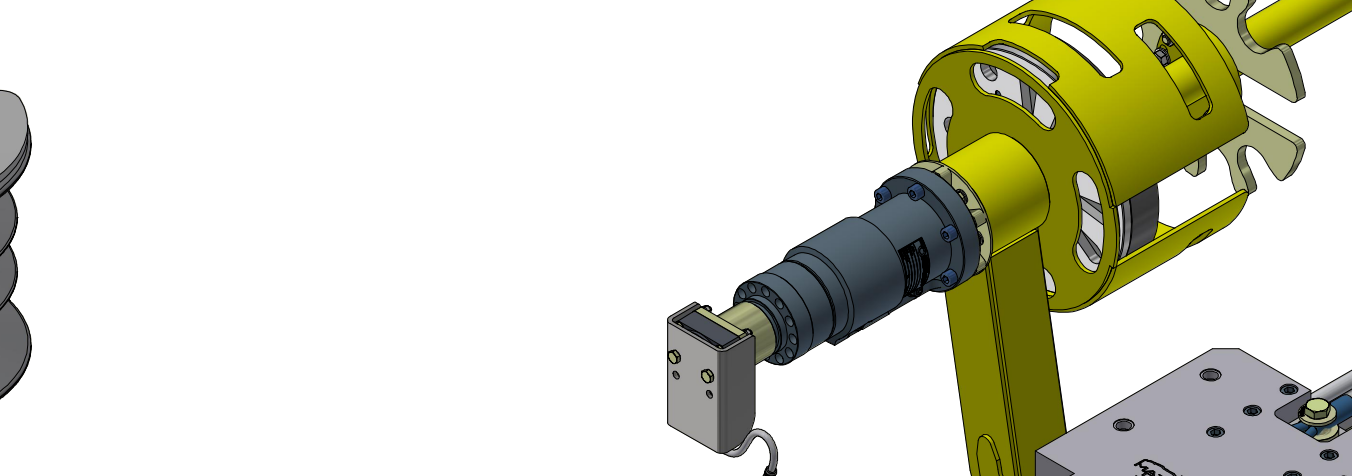

### MT3128 3141 08 CRADLE SET - REAR

ITEM	PART NUMBER	DESCRIPTION	QTY
1	MT3128 3141 07	CRADLE PLATE - REAR	1
2	MT0101 1951 28	PIN	1
3	MT3128 0785 48	SLIDE HOLDER RH	2
4	MT3128 3039 30	NYLON SLIDE SOFT (yellow)	4
4.1	MT3128 3039 31	NYLON SLIDE MID (blue)	0
4.2	MT3128 3074 88	NYLON SLIDE HARD (grey)	0
5	MT3128 0619 00	SLIDE KEY	12
6	MT3128 0785 49	SLIDE HOLDER LH	2
7	MT3128 3141 02	SPACER	2
8	MT3128 3141 03	GUIDE ASSEMBLY	1
9	MT0324 1550 65	BACK-UP RING	1
10	MT3128 2561 65	SHAFT	1
11	MT3128 2561 66B	BEARING	2
12	MT3128 2561 67	PULLEY - REAR	1
13	MT3128 0475 09E	HOSE REEL - EXTENDED	1
14	MT0666 6718 00	RADIAL LIP SEAL	2
15	MT3128 0475 105	HOSE REEL BEARING	2
16	MT3128 0486 00	SHAFT	1
17	MT3128 0497 00	CAP	1
18	MT3128 3141 05	SPACER	1
19	MT3128 3141 05P	HOSE REEL PROTECTION (not incl.)	0
20	MT3128 3141 05BK	BOLT KIT	1
21	MT3128 3141 07BK	BOLT KIT	1

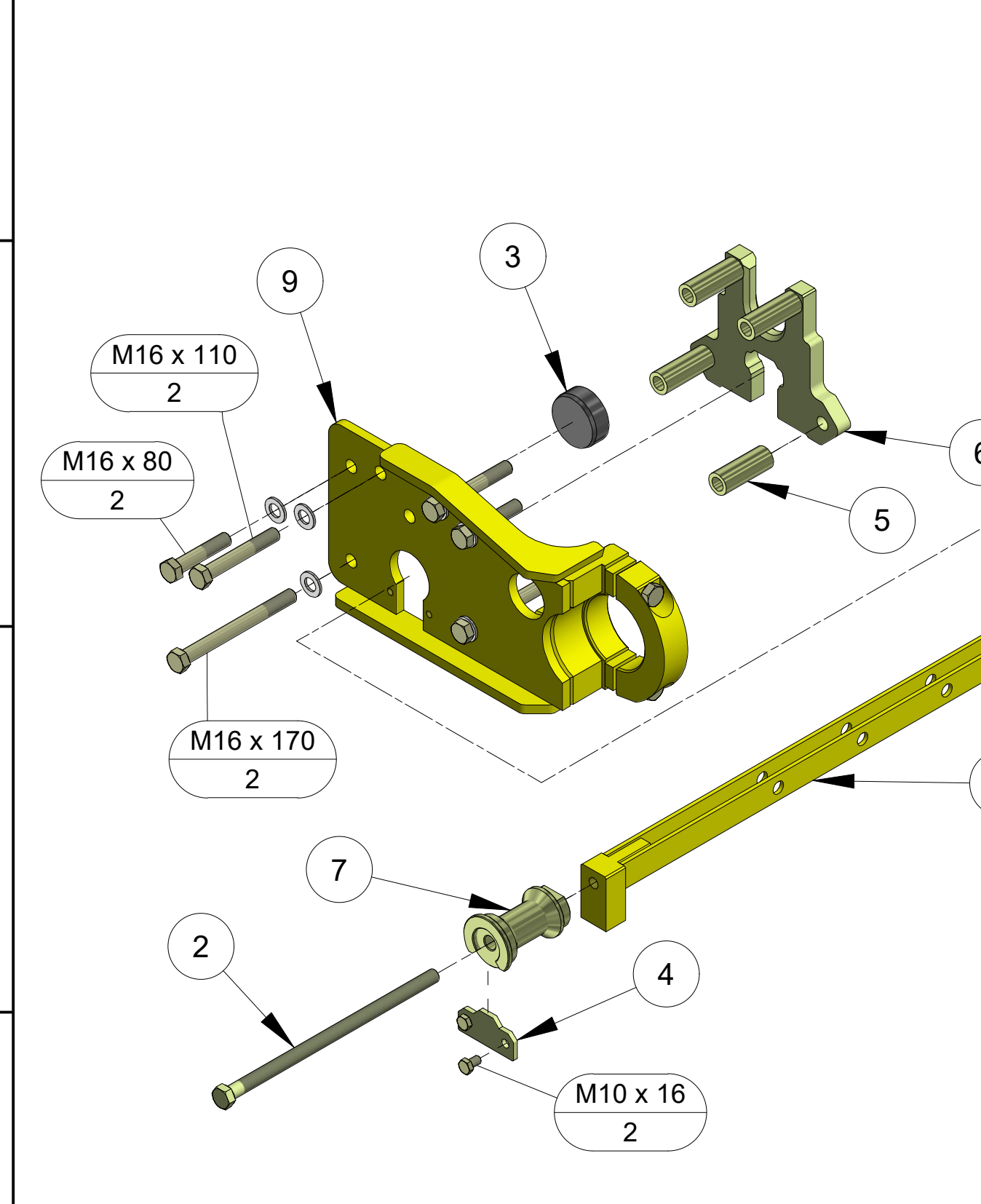

### MT3128 3141 2RA END PIECE SET REMOV. LADDER

ITEM	PART NUMBER	DESCRIPTION	QTY
1	MT0113 3238 00	PIN (incl. washer & split pin)	1
2	MT0147 1958 29	SET SCREW	1
3	MT3125 0639 00	BUFFER - REAR	1
4	MT3128 0476 0R	WASHER PLATE	1
5	MT3128 3051 75	PIPE	4
6	MT3128 3051 7R	END PIECE	1
7	MT3128 3051 8S	SPACER	1
8	MT3128 3135 91	ROPE LADDER	1
9	MT9111 4363 01	ATTACHMENT PLATE	1
10	MT3128 3141 2RBK	BOLT KIT	1



### MT3128 3150 25 CRADLE COMPLETE / MT3128 3140 99 CRADLE SHORT COMPLETE

ITEM	PART NUMBER	DESCRIPTION	QTY
1	MT3128 0609 00	SPACER	1
2	MT3128 0610 00	SPACER	1
3	MT3128 0619 00	SLIDE KEY	24
4	MT3128 0785 35	SLEEVE	1
5	MT3128 0785 36	WASHER	1
6	MT3128 0785 48	SLIDE HOLDER RH	4
7	MT3128 0785 49	SLIDE HOLDER LH	4
8	MT3128 3039 30	NYLON SLIDE SOFT (yellow)	8
8.1	MT3128 3039 31	NYLON SLIDE MID (blue)	0
8.2	MT3128 3074 88	NYLON SLIDE HARD (grey)	0
9	MT3128 3051 49	ATTACHMENT	1
10	MT3128 3052 25	DRIVER	1
11	MT3128 3052 251	DRIVER EXTENSION	1
12	MT3128 3141 01	SPACER	1
13	MT3128 3141 02	SPACER	4
14	MT3128 3150 24	CRADLE (extractor)	1
14.1	MT3128 3140 98	CRADLE SHORT (non extractor)	0
15	MT3128 3150 16T	THREAD SECTION	2
16	MT3128 3150 24P	PLATE (reversible)	1
17	MT3128 3142 78BK	BOLT KIT	1

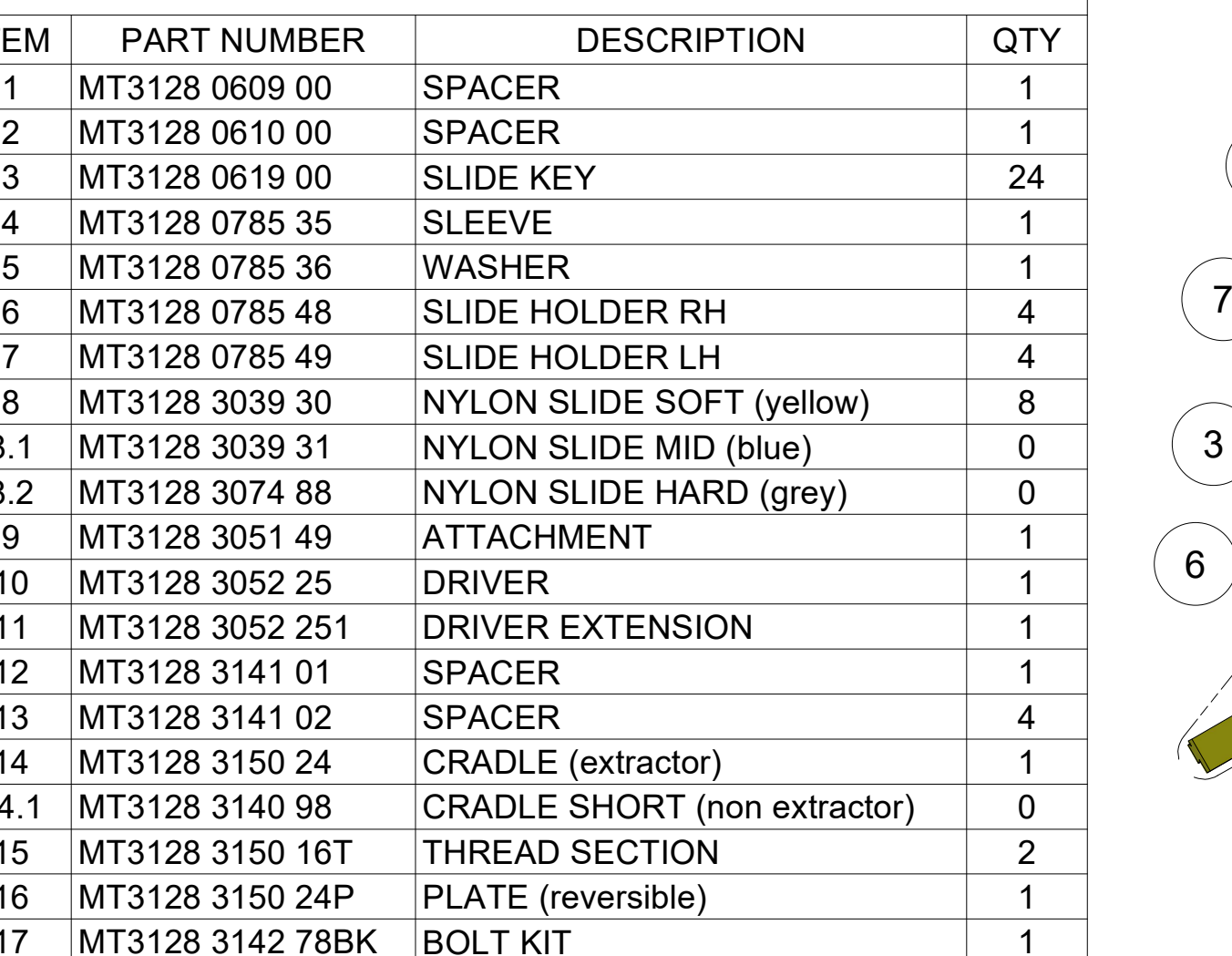

### PARTS

ITEM	PART NUMBER	DESCRIPTION	QTY
1	MT9111 4363 25	FEED BEAM (contact MT with machine specs)	1
2	MT3128 0458 01	CLIP-ON	4
3	MT3128 3257 23	FEED CYLINDER (service ex.)	1
4	MT6060 0024 59	SEAL KIT	1
5	MT3128 0784 730C	SPACER COMPLETE (MUX option)	1
5.1	MT3128 0784 580C	SPACER COMPLETE	0
6	MT9111 4363 66	CYLINDER - STINGER	1
7	MT3128 3112 50	CYLINDER - STINGER	1
8	MT3128 3152 63	SEAL KIT	2
9	MT9111 4363 656	STINGER FOOT ADAPTOR - ST45 (sold separate)	0
10	MT3128 3112 502	STINGER FOOT S7C - ST45 (sold separate)	0
11	MT9111 4363 654	STINGER BRACKET WASHER	2
12	MT9111 4363 65	BRACKET	1
13	MT9111 4363 04	BRACKET	1
14	MT3128 3139 08	HOLDER	1
15	MT3128 3105 18	MAGNET (incl. nuts & bolts)	1
16	MT3176 5409 002	DAMPER KIT COMPLETE	1
17	MT9111 4363 357	MAGNET HOLDING BRACKET	1
18	MT9111 4363 347	CLAMP BAR	1
19	MT9111 4363 13	SENSOR BRACKET	1
20	MT3128 0030 19	PROTECT COVER	1
21	MT9106 2192 17	LINEAR SENSOR RCS4	1
22	MT3128 2312 15	RETAINING PLATE	2
23	MT3128 3018 95	SHAFT	2

### MT3128 3148 CA8 EXTENSION HOSE TREE

ITEM	PART NUMBER	DESCRIPTION	QTY
1	MT3128 0715 00	HOSE GUIDE	1
2	MT3128 3148 P8	PROTECTION	1
3	MT3128 3148 H7	BULKHEAD	1
4	MT3128 3073 04W	HOSE ATTACHMENT WASHER	1
5	MT3128 3148 A7	ADDITIONAL BULKHEAD	1
6	MT3128 3148 C7FC	COMPLETE FITTINGS KIT	1

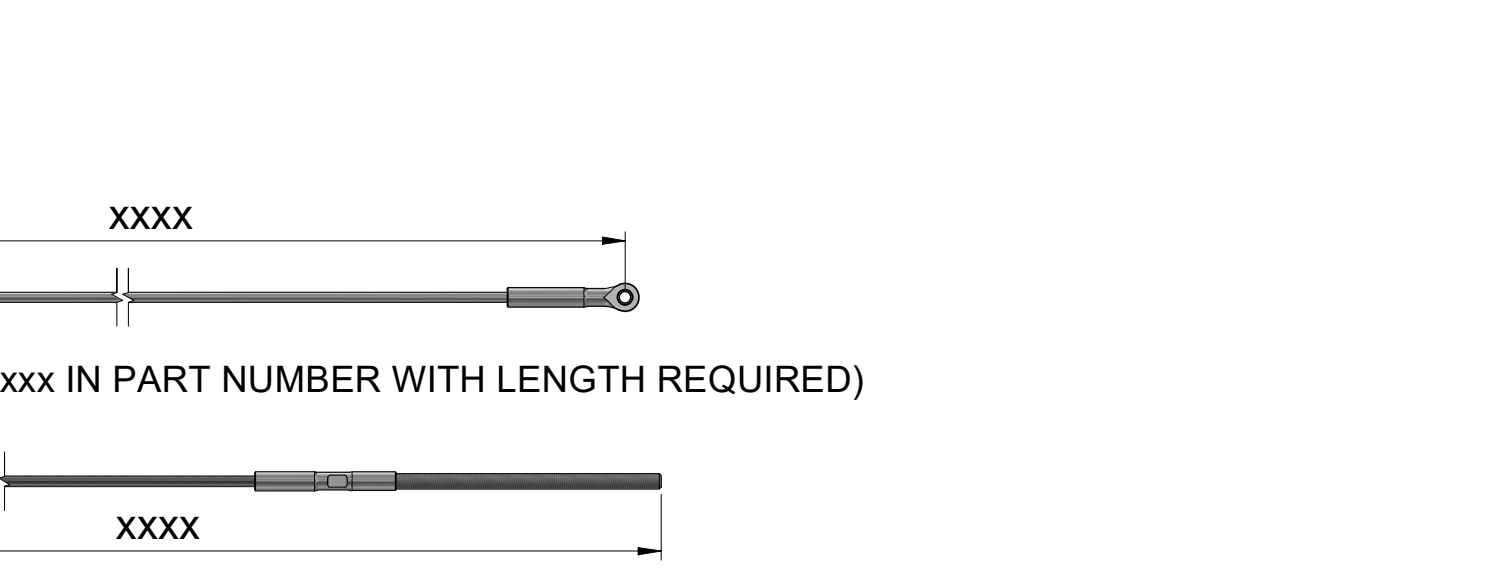

### ROPES

ITEM	PART NUMBER	DESCRIPTION	QTY
1	MT1128 402F 2F	PULL ROPE - 2840 1.2/1.5/1.8m 1257 S7	1
2	MT1128 002F 2M	RETURN ROPE - 2600 1.5/1.8m 1257 S7	1
3	MT1122 002F 2M	RETURN ROPE - 2200	1
4	MT1123 202F 2M	RETURN ROPE - 2320 1.2m	1
5	MT1129 002F 2F	PULL ROPE - 2900 1.5m	1
6	MT1126 602F 2M	RETURN ROPE - 2660 1.5m	1
7	MT1131 002F 2M	RETURN ROPE - 3100	1
8	MT11xx xx2F 2F	PULL ROPE	1
9	MT11xx xx2F 2M	RETURN ROPE	1

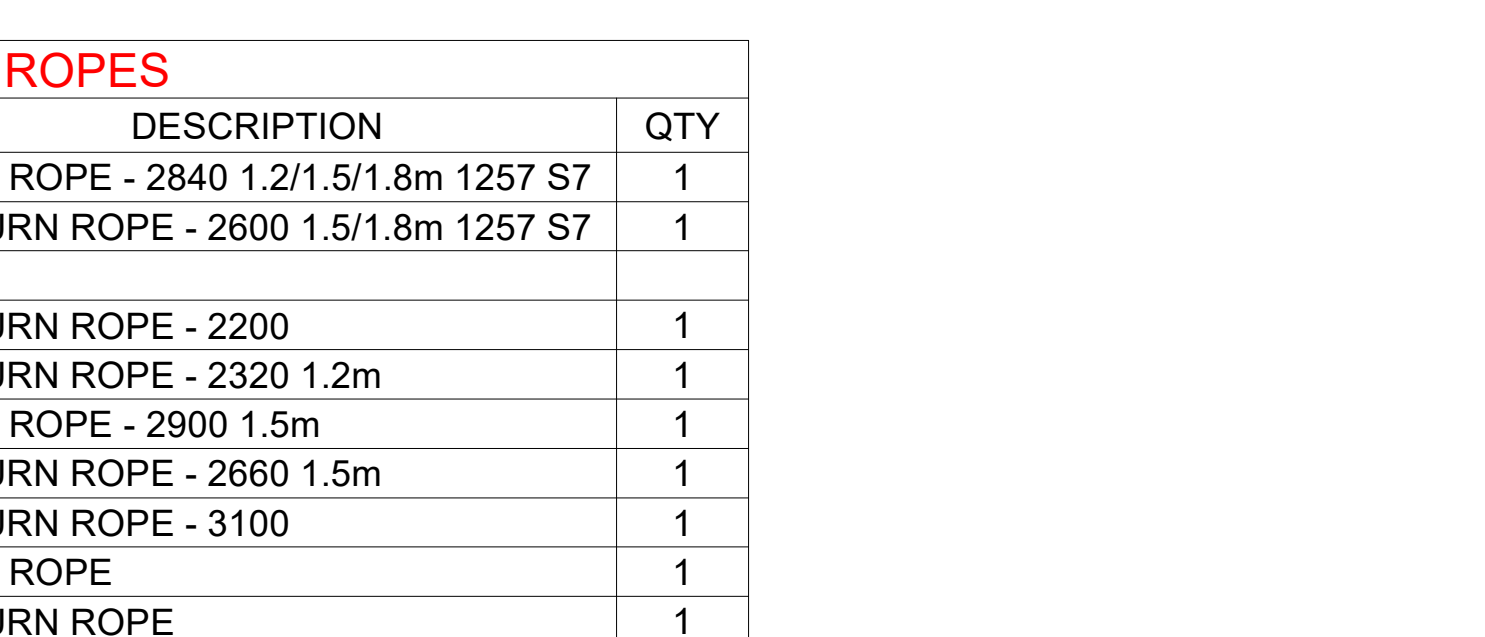

### MT3128 3140 32S CRADLE SET - FRONT (SHORT VERSION)

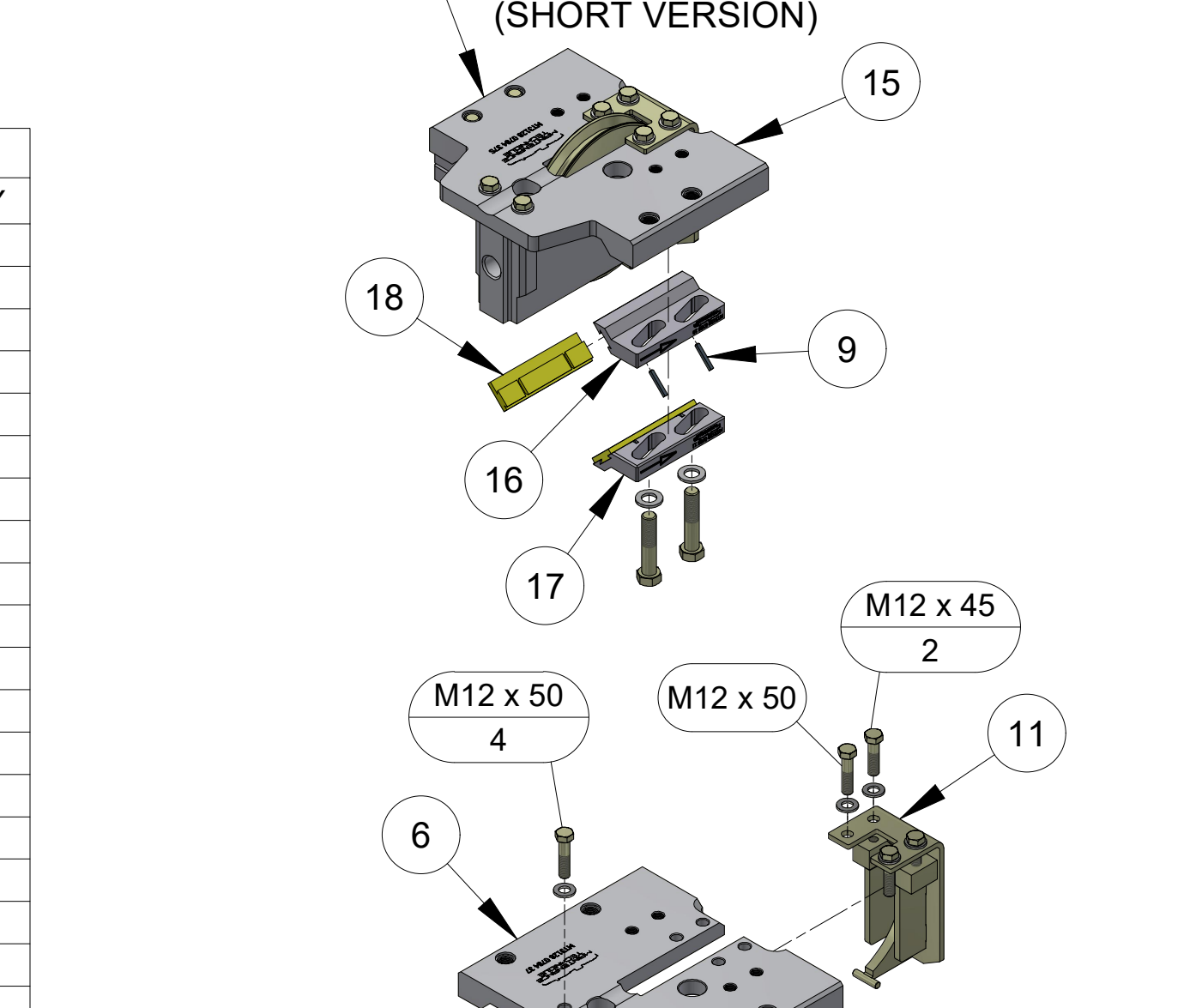

### MT3128 3140 13 HOLDER SET

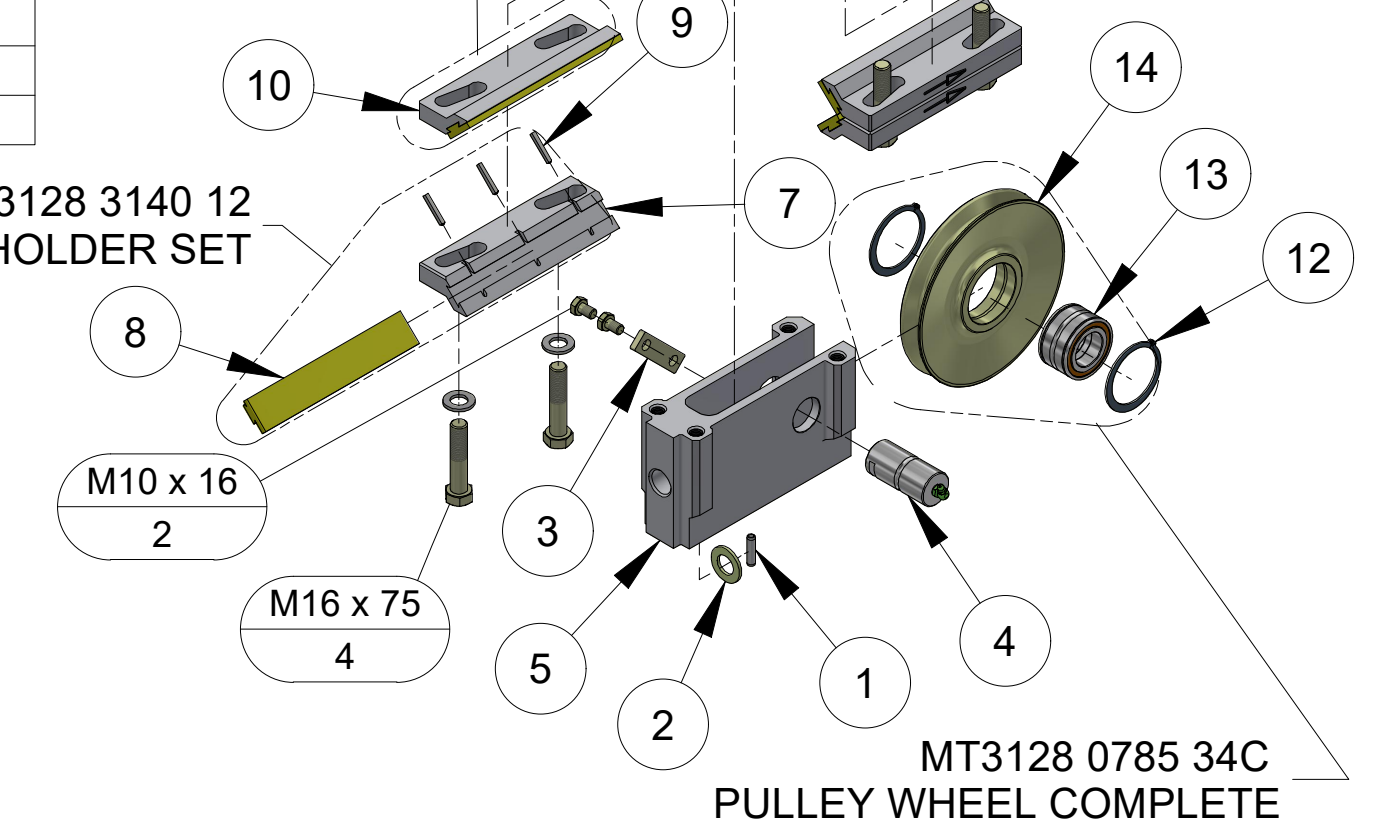

### MT3128 3140 32 CRADLE SET - FRONT

ITEM	PART NUMBER	DESCRIPTION	QTY
1	MT0108 3359 00	SPRING PIN	1
2	MT0301 2394 00	WASHER	1
3	MT3128 0476 00	WASHER PLATE	1
4	MT3128 0481 00	SHAFT	1
5	MT3128 0784 18	PROFILE	1
6	MT3128 0784 37	CRADLE PLATE	1
7	MT3128 0785 48	SLIDE HOLDER RH	2
8	MT3128 3039 30	NYLON SLIDE SOFT (yellow)	4
8.1	MT3128 3039 31	NYLON SLIDE MID (blue)	0
8.2	MT3128 3074 88	NYLON SLIDE HARD (grey)	0
9	MT3128 0619 00	SLIDE KEY	12
10	MT3128 0785 49	SLIDE HOLDER LH	2
11	MT3128 3061 47	WIPER	1
12	MT0335 1152 00	EXTERNAL CIRCLIP	2
13	MT3128 0784 27	ROLLER BEARING	1
14	MT3128 0785 34	PULLEY WHEEL	1
15	MT3128 0784 37S	CRADLE PLATE - SHORT	0
16	MT3128 3083 36S	SLIDE HOLDER RH - SHORT	0
17	MT3128 3083 37S	SLIDE HOLDER LH - SHORT	0
18	MT3128 3039 30S	NYLON SLIDE - SHORT	0
19	MT3128 3140 32BK	BOLT KIT	1

